



MaineHealth Mid Coast Hospital

# Annual Report 2025

**LEADERSHIP TEAM**

**Christopher T. Bowe, MD, FACEP**, *President*  
**Kristin Anthony, RN, MSN, NEA-BC**, *Chief Nursing Officer*  
**Natalie Talbot, MSN, RN, CPHQ**, *Senior Director, Quality & Safety*  
**Jeff Garnett**, *Senior Director, IS and Regional CIO*  
**Joe Grant, FACHE**, *Vice President, Operations*  
**Karin Spychalski**, *Director, Human Resources*  
**John Martins**, *Director, Communications and Public Affairs*  
**Maureen Perdue, DO**, *Chief Medical Officer*  
**Michael Perry**, *Chief Financial Officer*  
**Jana Purrell**, *Vice President, Physician Practice Operations*

**BOARD OF DIRECTORS**

**Pamela Bowerman**  
**Lenora Burke**, *Past Chairperson*  
**Marcus Deck, MD**  
**Kelly Elkins**  
**Catherine Fredricks-Rehagen, DO**, *Medical Staff President*  
**Charles Frizzle**  
**Glenn Hutchinson**  
**Peter Hutchinson, MD**, *Medical Staff Vice President*  
**Stemple Johnson, MD**  
**Margo Knight**  
**Bruce McGlaflin**, *Vice Chairperson/Secretary*  
**Alain Montegut, MD**  
**Adrian Moran, MD**  
**Daniel Morgenstern, MD**, *Chairperson*  
**Sandy Morrell Rooney**  
**Nicole Niven**, *Auxiliary President*  
**Matthew Orlando**, *Treasurer*  
**Sue Spann**  
**David Flaherty**, *Honorary Member*

**Table of Contents**

2025: Being a Part of Our Community ..... 4

By the Numbers ..... 5

Volunteer Profile: Meet Mary Boutin..... 6

Building the Future of Cancer Care ..... 8

MaineHealth Lifestyle Medicine: Expanding Access to Wellness and Prevention ..... 10

News and Highlights ..... 12

Donor Profile: Meet the Geigers ..... 20

Donor Report..... 22



**ON THE COVER**  
Mary Boutin and her pet therapy dog, Kenzy, spread a little sunshine to patients and staff at MaineHealth Mid Coast Hospital.



MAINEHEALTH MID COAST HOSPITAL

2025: Year in Review



Each year, the goal of the MaineHealth Mid Coast Hospital annual report is to provide a snapshot of the many accomplishments from the last year across our programs and services. It also serves as an opportunity to thank those who provide generous financial support of our work.

A theme that runs through the following pages is our connection with the community. You'll meet the chairs of this year's annual campaign and one of our exceptional pet therapy volunteers (as well as her horse, Elias, and her dog, Kenzy).

The grand opening of the MaineHealth Lois N. Skillings Health Center on the Parkview Campus, and our new Lifestyle Medicine program are also featured.

You will also get a glimpse of our exciting plan for a new cancer center. When completed, it will bring expanded IV therapy, cancer care, radiation oncology and innovative technology to the hospital campus. This project reflects a \$20 million investment by MaineHealth to support cancer care in our community.

To say we could not have achieved all this without you is an understatement.

We are fortunate to have so many corporators and donors whose involvement and generosity allows us to grow and sustain important services in the Midcoast. Those who wish to be recognized for their support are acknowledged in this report.

I am grateful for and humbled by your continued support, and I consider it a privilege to witness firsthand the unwavering commitment to high-quality, patient-centered care that our care team delivers every day.

I hope you feel a sense of pride and achievement as you read this report.

Sincerely,

Chris Bowe, MD, FACEP  
President, MaineHealth Mid Coast Hospital

By the Numbers (in thousands)

FUNDS RECEIVED	FY 2024	FY 2025
Amounts charged for patient services	\$724,805	\$796,508
Less portion not received due to Medicare, Medicaid and private insurance reimbursement rates paid at amounts less than charged	(\$420,507)	(\$462,315)
Less portion of amounts charged not received due to lack of patient ability to pay	(\$12,805)	(\$9,685)
Less portion of amounts charged that were provided to patients as free care	(\$5,498)	(\$8,464)
Net payments received from services provided to patients	\$285,996	\$316,044
Gifts, earnings on investments, COVID relief funding and other non-patient revenue	\$16,559	\$30,995
TOTAL FUNDS RECEIVED	\$302,555	\$347,040
FUNDS EXPENDED		
Salaries and benefits	\$158,925	\$172,914
Professional fees, purchasing services, supplies and taxes	\$112,248	\$119,060
Cost of facilities, depreciation, interest, other	\$23,053	\$24,174
TOTAL FUNDS EXPENDED	\$294,227	\$316,149
AMOUNTS EARNED FOR FUTURE INVESTMENTS IN PATIENT CARE AND COMMUNITY PROGRAMS	\$8,327	\$30,891





*Elias, a pet therapy horse, and his owner, Mary Boutin, visit with senior care residents regularly at MaineHealth Mid Coast Senior Health. He knows exactly how to engage with a resident during a therapy visit.*

## Volunteer Profile: Meet Mary Boutin

For the last 12 years, Mary Boutin has witnessed firsthand the therapeutic value and joy a pet can bring to individuals at any age.

Mary is one of the many volunteers who choose to bring their pets to visit hospital patients and senior care residents at MaineHealth Mid Coast Hospital and

MaineHealth Mid Coast Senior Health Center. “Sometimes, it’s just a smile or a quiet little pat that makes a difference in a person’s life,” she said.

Mary began her visits in 2013, with Sadie, her first therapy dog. She and Sadie visited many places together until Sadie passed away unexpectedly in 2019, and Mary found herself without a dog. Then COVID arrived in Maine and visits to health care facilities shut down.

When hospitals, schools and senior centers lessened visiting restrictions, Mary was back at it with her new yellow Labrador retriever, Kenzy, and her horse, Elias.

“Kenzy and Elias have the same personality. They have a calm, quiet old-soul presence,” she said. “I am a bit more mindful with Elias because of his size. But nothing startles him.”

Kenzy’s specialty is working with children, so along with visiting the hospital, they go to Harpswell Elementary, where the students read to them. Clarvida’s K-12 day school for children with autism spectrum disorders, developmental disabilities and mental health diagnoses is part of the visiting routine as well.

Mary and Elias’s special talents were on display when they visited MaineHealth Mid Coast Senior Health in the summer. One by one, a handful of residents had a few moments of their own engaging with the more than 20-year-old horse.

Elias clearly knew why he was there, lowering his nose and face so the residents could pet him. The connections between horse and human were powerful, and the smiles were contagious.

Staff at the health center are uplifted by the visits, as are care team members at the hospital when Mary and Kenzy arrive at their appointed rounds.

“I think we do as much good for the staff as we do for the patients and residents. They know our schedule, they see us more often, and they look forward to it,” Mary said. “It gives them a moment to themselves and a chance to smile during a busy or stressful day.”

Mary said the Alliance of Therapy Dogs offers certification through their program, which requires testing and three separate observations. She volunteers with the Alliance as an observer-tester when able, and she enjoys the experience.

So, what type of dog makes a good therapy dog? “A lot is just the dog’s natural disposition,” she said. “A well-rounded, socialized and well-behaved dog that enjoys meeting people, and an attentive owner, work best.”

Mary said she has no plans to stop doing what she loves in the next several years. She’s healthy, as are her animals.

“It is so rewarding for me to share my animals with people,” she said.



*MaineHealth Mid Coast Hospital nurses look forward to their weekly visits from Mary Boutin and Kenzy.*



*Mary Boutin and Kenzy breeze down the MaineHealth Mid Coast Hospital hallway on their way to visit patients on the Med-Surg unit.*



*Pet therapy volunteers and their pups participated in a Halloween Parade at the Senior Health Center this year.*





*This rendering of the new Cancer Care Center at 81 Medical Center Drive shows the exterior of the building, including the new vault for the linear accelerator.*

# Building the Future of Cancer Care

MaineHealth Mid Coast Hospital continues to make progress toward the creation of our new Cancer Care Center, an important step in our mission to provide high-quality, comprehensive care close to home. Over the past year, a series of major projects have moved us closer to realizing this vision, while strengthening services across our Mid Coast Hospital and Parkview campuses.

The newly completed MaineHealth Lois N. Skillings Health Center on the MaineHealth Parkview Campus is now home to all our ambulatory behavioral health services. The bright, welcoming space was designed to promote healing and connection, providing a

more comfortable environment for patients and care team members alike. We also renovated space to relocate the rheumatology practice, expanding access to specialty care for our community. The registration area was redesigned to offer a modern, inviting first impression for everyone who walks through our doors.

Several additional projects are already underway and will be completed by early 2026. Construction has begun to relocate our Neurology team to 121 Medical Center Drive, an important step in preparing for the new Cancer Care Center. Work is also in progress to move orthopedic therapy services to the MaineHealth Parkview campus, allowing us to expand this practice to meet growing community needs.

Looking ahead, 2026 will bring even more visible progress. Plans include renovating space at 81 Medical Center Drive to bring all oncology services together under one roof, building a vault for a new linear accelerator to provide radiation therapy, and constructing an external pharmacy to serve our infusion center and patients receiving cancer care.

“Each step is bringing us closer to our vision of the new Cancer Care Center,” MaineHealth Mid Coast Hospital President Chris Bowe, MD, said. “This work reflects the strength of our partnerships in MaineHealth and our shared commitment to providing exceptional care close to home. The project is about more than a new facility. It’s about bringing together the people, expertise and resources to support our community through every stage of cancer care.”

If you would like to make a gift to support MaineHealth Mid Coast Hospital, or have any questions, please contact Seth Martin by phone at **207-373-2247** or email **[seth.martin@mainehealth.org](mailto:seth.martin@mainehealth.org)**.

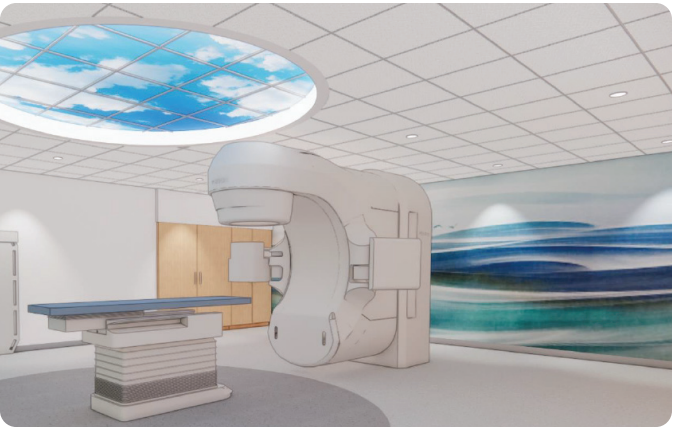

*Rendering of the linear accelerator that will be installed at the new Cancer Care Center at 81 Medical Center Drive.*



*The new IV therapy space will feature a comfortable layout and provide patient privacy.*





*Estelle Krestos, RN, MaineHealth Lifestyle Medicine community nurse educator and wellness coordinator, prepares for an Art of Wellness class.*

## MaineHealth Lifestyle Medicine: Expanding Access to Wellness and Prevention

In October, MaineHealth Mid Coast Hospital celebrated the re-naming and expansion of its Lifestyle Medicine program with a community open house at the MaineHealth Mid Coast Hospital Parkview Campus. Formerly known as the Mid Coast Center for Community Health and Wellness, MaineHealth Lifestyle Medicine Brunswick now offers a broader range of programs designed to help community members prevent, treat and reverse chronic disease through science-backed lifestyle changes.

The open house welcomed neighbors and friends for an evening of live music, refreshments and interactive demonstrations highlighting the six

pillars of lifestyle medicine: whole food, plant-predominant nutrition; regular physical activity; restorative sleep; stress management; avoidance of risky substances; and positive social connection. Guests toured new spaces, including the Social Hub and Food Pantry, and met the care team members leading these transformative programs.

Lifestyle Medicine is at the heart of MaineHealth's vision of "working together so our communities are the healthiest in America." By addressing the root causes of disease, the program provides practical tools and resources to support healthier living, especially for individuals managing chronic conditions such as heart disease, type 2 diabetes, high cholesterol and obesity.

"We have been providing excellent health, wellness and education programs for many years," MaineHealth Lifestyle Medicine Brunswick Director Cate Parker said. "We

are very excited to enhance our offerings by focusing on proven lifestyle medicine interventions. These programs allow us to partner with people to focus on positive lifestyle changes which both treat and prevent chronic health conditions. Small, deliberate and sustainable changes have a lasting impact on health. We're excited to expand our programs and provide more opportunities for our community to live healthier lives."

Programming spans a wide variety of interests and needs, from nutrition education such as Food Is Medicine and Celebrity Chef demonstrations, to fitness opportunities including Walk With a Doc and Yoga for Daily Living. Stress reduction classes, restorative sleep workshops, tobacco treatment support and health education series like Understanding Parkinson's Disease further round out offerings that focus on the whole person.

The emphasis on community connection is also central to MaineHealth Lifestyle Medicine's mission. The new Social Hub at the Parkview Campus provides a welcoming place for participants to engage with one another, fostering relationships that enhance both emotional and physical health. These initiatives create pathways to healthier living that go beyond traditional medical care, empowering people to take an active role in their well-being.

As MaineHealth Lifestyle Medicine expands, it continues to embody MaineHealth's

commitment to prevention and whole-person care. The program stands as a vital resource for residents of the Midcoast region and offers proven strategies to improve health outcomes and quality of life.



*Seth Martin, director of philanthropy, Chris Bowe, MD, president of MaineHealth Mid Coast Hospital and a guest visit during the MaineHealth Lifestyle Medicine open house.*



**Scan QR code to learn more or sign up for a MaineHealth Lifestyle Medicine Brunswick program.**



# News and Highlights

## Mid Coast Senior Health Earns National Recognition for Quality Care

MaineHealth Mid Coast Senior Health was honored this year with the Bronze Commitment to Quality Award from the American Health Care Association and National Center for Assisted Living (AHCA/NCAL). This national recognition celebrates the team’s dedication to improving the lives of older adults through high-quality, compassionate care.

The AHCA/NCAL National Quality Award Program is a rigorous, multi-step process based on the Baldrige Performance Excellence Program standards. By earning the Bronze award, the team has demonstrated a structured, data-driven



The Mid Coast Senior Health team, from left: Director of Nursing Stacey Morse, RN; Manager of Residential Services and Marketing Carrie Pelletier, RN, BSN; Manager of Facilities Operations Jeffrey Darling; Administrator Kim Watson, MS, SLP, MLNHA; and Manager of Clinical Operations and Compliance, Infection Preventionist Teresa Smith, PP-OTD, with the Bronze Commitment to Quality Award at the MHCA Fall Conference in October.

approach to advancing care quality and is now eligible to pursue silver- and gold-level recognition in the years ahead.

Located in Brunswick — recently named one of the best towns for retirees in Maine — MaineHealth Mid Coast Senior Health provides high-quality health care and residential services designed to help older adults achieve the highest possible quality of life and level of independence. With easy access to multiple levels of care in one location, residents and their families develop long-term, trusted relationships with their care team. Being fully integrated with MaineHealth ensures seamless access to expert primary and specialty care through MaineHealth Mid Coast Hospital and the larger MaineHealth system.

This achievement reflects the commitment of the entire MaineHealth Mid Coast Senior Health team and underscores its role as a cornerstone of senior care in Midcoast Maine.

## Recognizing Excellence: Awards, Certifications and Accreditations

In 2025, MaineHealth Mid Coast Hospital continued to earn state and national recognition for excellence in patient care, public health and environmental stewardship. These awards and certifications reflect our ongoing commitment to quality, safety, innovation and community health, as well as the dedication of our care teams who make these achievements possible.

## MID COAST CONTINUES TOP PERFORMANCE IN BREATHE EASY PROGRAM

In April, MaineHealth Mid Coast Hospital received Platinum-Level Recognition from the MaineHealth Center for Tobacco Independence’s Breathe Easy Initiative. This Gold Star Standards of Excellence Award highlights our comprehensive smoke- and tobacco-free campus policies and our commitment to helping patients quit tobacco. Facilities across the state were evaluated on best practices such as screening for tobacco use, referring patients to treatment and training staff in tobacco intervention.



## ENVIRONMENTAL SUSTAINABILITY PROGRAM EARNS GREENHEALTH AWARD

Environmental sustainability was another area of achievement in 2025. MaineHealth Mid Coast Hospital earned the Practice Greenhealth Partner for Change Award, joining only about 260 hospitals nationwide recognized for superior performance in energy conservation, waste reduction and mercury elimination. This award underscores our ongoing efforts to

integrate environmental stewardship into daily operations. These initiatives included installing pipe and jacket insulation to reduce thermal energy loss, creating a blue wrap art project to promote awareness of surgical waste and beginning a five-year sustainable landscaping transformation.



From left: MaineHealth Mid Coast Hospital President Chris Bowe, MD; Food and Nutrition Services Director Emily Day and Vice President of Operations Joe Grant with the Practice Greenhealth Partner for Change Award plaque.

## MAINEHEALTH MID COAST HOSPITAL NAMED LARGE BUSINESS OF THE YEAR

In addition to clinical and environmental honors, MaineHealth Mid Coast Hospital was named the Large Business of the Year by the Bath-Brunswick Regional Chamber of Commerce. This award recognizes the hospital’s commitment to the community through volunteerism, leadership and innovative employment practices. As one of the region’s largest employers, the MaineHealth Mid Coast Hospital supports other local nonprofits, welcomes new Mainers into the workforce, fosters career and technical education programs, and



promotes initiatives around transportation, housing and child care.

Together, these honors demonstrate MaineHealth Mid Coast Hospital’s leadership in delivering high-quality care, fostering healthier communities and advancing innovation. They also reflect the dedication of our care team members who continually strive to exceed standards and provide exceptional care to every patient, every day.



From left: Chamber President and MHMCH Senior Director of Operations Joe Grant; (former) MHMCH Philanthropy Director Connie Jones-Morris; MHMCH President Christopher Bowe, MD; and Executive Director of the Bath-Brunswick Regional Chamber Executive Director Cory King. Photo courtesy of the Pierce Studio.

**Celebrating Care Team Excellence**

In 2025 MaineHealth Mid Coast Hospital proudly recognized the dedication, skill and compassion of its care team members through a variety of individual and team awards. These honors reflect our commitment to delivering exceptional patient care, fostering teamwork and upholding MaineHealth’s core values across all settings.

This year’s Gordy Award was presented to Melinda Cota, senior patient access associate, for exemplifying the MaineHealth values of excellence, integrity and ownership. The award, established in memory of John G. “Gordy” Johnson, recognizes Patient Access team members who consistently go above and beyond to support patients and colleagues.



MaineHealth Mid Coast Hospital Senior Patient Access Associate Melinda Cota with her Gordy Award.

**NURSING EXCELLENCE RECOGNIZED DURING CARE TEAM APPRECIATION WEEK**

Nurses at MaineHealth Mid Coast Hospital continued to be recognized nationally through the DAISY Award for Extraordinary Nurses. Carrie Walker, an RN in the Ambulatory Care Unit, received individual recognition for her compassionate, skillful care and attention to patient needs. The Medical-Surgical Unit team was honored with the DAISY Team Award® for providing exceptional, patient-centered care to a patient over a three-year period, demonstrating teamwork, resilience and



Carrie Walker (center), RN, poses behind the Daisy Award banner with MHMCH Chief Nursing Officer Kristin Anthony (left) and Misty Foster.



Members of the Medical-Surgical Unit Amber Doyle, Haylee Paione, Jill Weybrant and Cindy Smith with the DAISY Team Award banner.

empathy in the face of complex medical and social challenges.

The hospital also recognized team members through the Spotlight Awards, which highlight exceptional service and dedication. Lily Bubar, wellness coordinator at Thornton Hall Assisted Living, and Lynn Jackson, a social worker on the care management team, were honored for their professionalism, compassion and efforts to support residents, patients and their families through challenging care transitions.



Lily Bubar and the Thornton Hall team (top); Lynn Jackson (bottom).



During Care Team Appreciation Week, the newly established Nursing Excellence Awards celebrated nurses demonstrating clinical excellence, mentorship and evidence-based practice. This year's recipients included Lisa Sullivan (Nursing Excellence), Derek Bascom (Emerging Professional), Sam Rivero (Preceptor & Mentor), Sarah Laskey (Evidence-Based Practice) and Allison Reynolds (Partner in Practice). These awards reflect the skill, compassion and commitment that define nursing at MaineHealth Mid Coast Hospital.



Nursing Excellence Awardees Lisa Sullivan, Sarah Laskey, Sam Rivero and Derek Bascom pose with their awards in the healing garden at MaineHealth Mid Coast Hospital.

**Celebrating Pride Month at MaineHealth Mid Coast Hospital**

MaineHealth Mid Coast Hospital proudly celebrated Pride Month with events and resources highlighting our commitment to inclusion and support for the LGBTQ+ community.

The month began with a Pride flag raising on June 2 at 123 Medical Center Drive, where

President Christopher Bowe, MD, read a poem to mark the occasion. From June 2-6, an information table outside the hospital café offered educational resources for patients, visitors and care team members. Hospital representatives, including the Community Health team, also joined Bath Pride at Waterfront Park on June 13 and Brunswick Pride at the Brunswick Mall on June 14.



MaineHealth Mid Coast Hospital President Christopher Bowe, MD, opens Pride Month with a flag raising on the hospital campus.

**New Behavioral Health Center Opens on Parkview Campus**

MaineHealth Mid Coast Hospital marked an important milestone this year with the opening of its newly renovated Behavioral Health Center on the MaineHealth Parkview Health Center campus. By bringing services together from three separate locations into one, the center improves access, coordination and continuity of care, helping patients stay engaged in treatment and on the path to wellness.

At the ribbon cutting on June 3, community members and care team providers heard firsthand how access to behavioral health care can change lives. Mandy Lewis, who has been in recovery for six years, shared how the support she received from MaineHealth Behavioral Health providers helped her find stability and maintain sobriety. “You have to keep trying to be sober,” she said. “It took me several years and a lot of support from family and many different caregivers to succeed. The programs offered at this location can start you on your journey to sobriety and keep you there.”

The new center honors the legacy of former Mid Coast Hospital President Lois Skillings, RN, who was recognized for more than 43 years of service to the community. Named the MaineHealth Lois N. Skillings Health Center, the facility stands as a testament to her vision of compassionate, patient-centered care.



Leaders and board members from MaineHealth flank Lois Skillings, former president of MaineHealth Mid Coast Hospital as she cuts the ribbon on the new behavioral health center.

**MaineHealth Food Pantry Opens in Brunswick**

The MaineHealth Food Pantry Brunswick, located at the MaineHealth Parkview Campus, opened its doors this year to help address one of the most fundamental needs for good health: access to nutritious food. Currently serving patients and care team members at the Parkview Campus and Walk-In Care Brunswick, the pantry is designed to expand in the future to support the wider community.

Set up like a small market, the pantry offers free, healthy food in a confidential and welcoming space. By providing access to fresh produce and nutritious staples, the pantry reinforces the critical connection between diet and overall well-being, ensuring patients and care team members can focus on health without the added stress of food insecurity.

This initiative is made possible through a partnership with Mid Coast Hunger Prevention Program and through the dedication of our care team members who refer patients and help spread the word.



The new food pantry at the MaineHealth Parkview Campus is a resource for both patients and care team members.



**Dr. Nirav Shah Headlines Paris Lecture at MaineHealth Mid Coast Hospital**

How prepared are we for the next pandemic? That pressing question was the focus of this year’s Herbert and Harriet Paris Healthcare Leaders Lecture, hosted by MaineHealth Mid Coast Hospital on July 10. The event welcomed Dr. Nirav Shah, a nationally recognized public health leader and former director of the Maine Center for Disease Control and Prevention, as keynote speaker.

Dr. Shah drew on his extensive experience guiding Maine through the COVID-19 pandemic to reflect on lessons learned and to explore how health care systems can better prepare for future public health challenges. His presentation highlighted both the critical role of local health systems in times of crisis and the importance of collaboration across sectors to ensure communities are resilient in the face of uncertainty.



*Dr. Nirav Shah speaks to the audience at the Herbert and Harriet Paris Lecture at Bowdoin College.*



*MaineHealth Mid Coast Hospital President Chris Bowe, MD, leads the audience in recognition of Herb Paris.*

The Herbert and Harriet Paris Healthcare Leaders Lecture, established in 2011 through an endowment, was created to bring national voices in health care to Mid Coast Hospital and to spark meaningful conversations that reach beyond the walls of the hospital. By addressing topics of broad importance, the lecture series strengthens the connection between health care providers and the communities they serve.

This year’s lecture underscored the enduring value of the series: creating a forum where local clinicians and community members can engage with national leaders on the issues that matter most to the health and well-being of our region.

**Trek Across Maine: Pedaling for a Purpose**

Care team members from MaineHealth Mid Coast, Pen Bay and Waldo Hospitals, as well as long-time community supporters came together this summer to ride in the 41st annual Trek Across Maine, raising more than \$18,000 in support of lung health.

The team’s dedication and determination earned them a spot among the top five fundraising teams, helping the American Lung Association bring in a total of \$687,000 to advance research, education and advocacy in the fight against lung cancer, COPD, asthma and other serious lung diseases.

Leading the charge was team captain Janet Moore, RN, from the Mid Coast Hospital Cardiology department. Under her leadership, the group trained, fundraised and ultimately rode 165 miles over three days.



*The 2025 MaineHealth Mid Coast Hospital Trek Across America team.*

**Stroke Care Program Earns National Accreditation**

MaineHealth Mid Coast Hospital achieved Primary Stroke Center re-certification from The Joint Commission following a rigorous unannounced review. This certification signals that we provide expert, around-the-clock stroke care using advanced diagnostics, clinical best practices and continuous performance improvement to support better outcomes for patients.







*In their free time, Margie and Jeff Geiger enjoy taking van trips to unique places, like Glacier National Park (above) in northwest Montana on the U.S.-Canada border.*

## Donor Profile: Meet The Geigers

Margie and Jeff Geiger understand the importance of giving back.

Since coming to Bath, the Geigers have supported organizations like the United Way, the Patten Free Library, the Bath YMCA and MaineHealth Mid Coast Hospital. They've served as board members, volunteers and made donations to many important causes.

If you look back at any major expansion project, like the high school expansion, the YMCA childcare expansion, or the merger between Bath Memorial Hospital and Regional Memorial Hospital that formed Mid Coast Hospital in 1991, the Geigers were actively involved.

Now, in 'retirement,' the Geigers seem busier than ever.

"When I see people at a community meeting, they'll ask 'What hat are you wearing tonight?' " Margie said. "We feel fortunate to be in this community, and we think it is pretty important to do what we can."

The journey to Midcoast Maine began in 1983, when Jeff came to Bath Iron Works (BIW) from the University of Michigan. He was studying naval architecture and marine engineering and looking for practical experience.

"There are not many internships out there. It's a pretty specialized field," he said. "Bath Iron Works was a leading shipyard, so I came here for my undergraduate internship and before returning to Michigan for graduate school."

Margie attended a smaller university in Michigan, and after Jeff and Margie were married in 1984, they headed back east to return to Maine. Jeff had accepted a job at BIW, while Margie worked as an office nurse at the then Parkview Adventist Hospital in Dr. Myron Krueger's internal medicine office.

The Geigers raised two children here; both were born at Parkview. As their children grew, they were impressed with the schools, along with the commitment of fellow parents and the community.

"The schools were great, the parent support of the schools was strong and the families were terrific. We also had the Maritime Museum, the library, a great downtown and

much more. It was a wonderful place to raise a family," said Margie.

Jeff began his career as a production planner at the shipyard. "I loved the internal operations, construction activities, and the skill and pride of the tradesmen building a super complex project," he said.

Jeff rose through the management ranks and was the president of BIW from 2009-2013. He then was transferred by General Dynamics to serve as president of Electric Boat, where he oversaw submarine production at facilities in Rhode Island and Connecticut.

"While I missed BIW, I enjoyed the challenges of building nuclear-powered submarines. The regulatory and quality standards are much more rigorous," he said.

While Jeff and Margie describe their family health care needs as routine, they were impressed by the care and services provided locally.

"The quality of the physicians and the nursing care was amazing," Margie said. "The administration was terrific ... ." The closure of Bath Memorial Hospital was a big deal in town. Many people weren't happy, but the leaders knew just how to manage that and see it through."

As health care costs and insurance premiums soared during Jeff's time at BIW, he was impressed that Mid Coast Hospital Presidents Herb Paris and Lois Skillings

initiated conversations and proposed different ideas to focus on employee wellness and reduce the cost to employers.

"Health care was one of our largest overhead costs," he said. "They recognized this was a big deal for BIW, and they reached out. As a result, we did a lot in partnership over time."

Today, when the Geigers have free time, they enjoy sailing along the Maine coastline.

"Some of the best sailing waters in the world are here in Maine," Jeff said. "The beauty of the Maine coastline and all the islands make it a playground to enjoy while under sail."

They also love to travel abroad and spend time "not too far off the grid" on road trips living the van life. And when winter rolls around, it's off to the slopes at Sugarloaf.

The Geigers chose to chair this year's Annual Campaign because they know the importance of both local care and local philanthropic support.

"When I look around the state seeing health care facilities going away and services becoming limited, I recognize we are fortunate to be in a place where MaineHealth is investing and growing the services," Jeff said. "MaineHealth is invested in us, and I think it's important for the community to show we are invested, too."



Donor Report

CAPITAL CAMPAIGN

Carol Aderman  
*In Honor of MaineHealth*  
Androscoggin Bank  
Anonymous  
Kristin and Richard Clark  
*In Honor of Lois Skillings*  
Mid Coast Hospital Auxiliary  
Conny Barker  
Roger Barras  
*In Memory of Connie Barras*  
Lee Barth  
Bath Iron Works  
Bath Savings Institution  
Bowdoin College  
Stephanie and Christopher Bowe, MD  
Frances and Bill Bowen  
*In Memory of Mr. and Mrs. John G. Morse, Jr.*  
Pamela and Lloyd Bowerman  
Jo and Ed Bradley  
Sean and Jana Burke  
Lennie Burke and Bob Beaumont  
Cynthia Bush  
Steven and Joanne Caulfield  
*In Honor of Lois Skillings*  
Darlene Chalmers and Richard Linehan  
Baer Connard  
Crooker Construction  
*In Memory of Kaylee Turcotte*  
Beth Cullum  
Marla and CR Davis  
*In Memory of Ruby Ann Davis*  
Marcus Deck, MD and Sarah Deck  
Carl DeMars, MD and Rebecca DeMars  
Betsy Eaton  
Stacy Frizzle-Edgerton and Jonathan Edgerton  
*In Honor of Juliet Frizzle*  
Kelly Elkins  
John and Deborah Farnham  
Betsy and Mike Fear

Sumner and Diane Field  
*In Memory of Grace Field and Dorothy Collins*  
First Federal Savings  
Catherine Fredricks, DO and Rep. Daniel Ankeles  
Charles and Carol Frizzle  
Jeff and Margie Geiger  
Carolyn Gibson  
*In Memory of Rev. Brick Gibson*  
John and Linda Gillespie  
William Glidden and Katherine Lyon  
*In Memory of Barbara Lyon and Jane Glidden Burton*  
Joe and Melissa Grant  
Terry and Sally Gray  
Patricia Gribben  
Bill and Sally Haggett  
Robert and Margery Healing  
Curtis Henderson  
*In Memory of Diane C. Francis*  
Lester and Sydney Hodgdon  
Glenn and Ellen Hutchinson  
Peter Hutchinson, MD and Rebecca Hutchinson, MD  
Stemple Johnson, MD and Catherine Johnson  
Constance Jones-Morris and Sam Morris  
Robert and Ruth Kingsbury  
Margo and David Knight  
Nathan and Janine Lipfert  
*In Memory of Gilman and Irene Langlais*  
Macauley and Carol Lord  
*In Memory of Reb. Bob Patterson*  
Abigail Manny Patterson  
*In Memory of Tim Adams*  
Deborah Mayerson and George Hart  
Robert and Barbara McCue  
Bruce and Helene McGlaufflin  
Alain Montegut, MD and Kathleen Montegut  
Sarah and Adrian Moran, MD  
Dan Morgenstern, MD and Moriah Moser  
Doug and Georgette Morrell  
Eleanor Morrell

Sandy Morrell-Rooney and Chuck Rooney  
John and Betsey Morse  
Diane Moyer  
Will and Pia Neilson  
The Niven Family  
*In Memory of Campbell B. Niven*  
Stephen and Jacqueline Norman  
Gerry Orem  
Matthew and Carrie Orlando  
Catharine Paiste  
Herbert and Harriet Paris  
Andrea and Todd Patstone  
Maureen Perdue, DO  
Michael and Michol Perry  
Arthur and Deborah Pierce  
*In Memory of Alice P. Balcer*  
Sara Pratt  
*In Honor of John and Betsey Morse*  
Jana Purrell and Brad Swanson  
Peter and Marilyn Reed-White  
James Rines, MD and Michelle Rines  
Cheryl Rust  
Lois and Jim Skillings  
*In Honor of Pat Conner*  
Ervin and Wanda Snyder  
Sue and Donald Spann  
Ann Springhorn  
John and Margie Sunderland  
Dr. David and Anne Taft  
Lloyd Van Lunen, MD and Margaret Wilson  
Bruce and Susan  
Mark Wheeler, MD  
Linda and Dan Wood, MD  
JB and Loren Wright

MID COAST HOSPITAL ANNUAL GIVING

TOWER CLUB \$10,000+

Mid Coast Hospital Auxiliary  
John Boomer  
Cynthia Bush  
BlueWater Health  
Pat Hennin  
*In Memory of Patsy Hennin, The Hennin Family Endowment*

Brunhilde Kunzel  
Messier-Costain Foundation  
Daniel Morgenstern, MD and Moriah Moser  
Eleanor Morrell  
Sandy Morrell-Rooney and Chuck Rooney  
Gerry Orem  
Joan Reynolds  
Cheryl Rust  
*In Memory of Marie Forbes, In Memory of Nick Hyde, MD*  
Richard Stephenson  
Spark Cycling Studio LLC  
Anonymous

PRESIDENT'S CLUB \$5,000-\$9,999

Rosemary and Eric Anderson  
Stephanie and Christoper Bowe, MD  
Crooker Construction, LLC  
Marla and CR Davis  
William and Sandra Guild  
Sally Haggett  
Stemple Johnson, MD and Catherine Johnson  
*In Memory of Nick Hyde, MD*  
Robert and Ruth Kingsbury  
John and Betsey Morse  
Abigail Manny Patterson  
McLanathan-Phippsburg Fire & Rescue Fund  
Kevin and Sheila McManus  
James Rines, MD and Michelle Rines  
Lois and Jim Skillings  
*In Honor of Pat Conner*  
The Casey Family Foundation  
Spectrum Healthcare Partners

PACESETTER \$2,500-\$4,999

Bowdoin College  
Jacqueline and William Brauer  
*In Memory of Shirley and Charles Richelieu*  
Stephen and Joanne Caulfield  
William and Helene Chase  
Beth Cullum

Carl S. DeMars, MD and Rebecca DeMars  
Robert and Blythe Edwards  
John and Deborah Farnham  
Diane and Sumner Field  
Jeffrey and Marjorie Geiger  
Patricia Gribben  
Glenn and Ellen Hutchinson  
Alison Luck  
*In Memory of Patricia Murphy*  
Michael and Michol Perry  
Charles L. Read Foundation  
Philip and Carolyn Schrodel  
Captain John and Laurel Spear  
*In Memory of Mary Packard*  
John and Margie Sunderland

DIRECTOR \$1,000-\$2,499

Modern Woodmen of America  
Don and Judy Auten  
Rae Bachelder  
Gregory and Donna Barmore  
John and Jane Berry  
Susan Blagden  
MC Susan Blagden Endowment  
*Fund in Honor of Dr. Daniel H. Wood*  
Alexander Bennett and Brooksley Born  
Frances and Bill Bowen  
*In Memory of Mr. and Mrs. John G. Morse, Jr.*  
Laurie Brunswick  
*In Memory of Kathy Larsen*  
Philip Cantelon and Eileen McGuckian  
Elizabeth Childs  
Kelly Elkins  
Jacqueline Ellis  
Lora Fleming  
*In Honor of Callie, Lauren, Caroline, Kimberly and Dr. Mac Henry*  
Robert and Marta Frank  
Carolyn Gibson  
*In Memory of Rev. Brick Gibson*  
James and Susan Gillies  
Conny and Dave Graft  
Terry and Sally Gray

The John A. Hartford Foundation  
Robert and Margery Healing  
Kristin Hite  
Sebastian Jablonski, DO and Lisa Yeh, DO  
Donald Kelley  
*In Memory of Betty Kelley*  
Margo and David Knight  
Shelly Korman  
*In Memory of Rev. Mary Harrington*  
Langford & Low, Inc.  
Lavallee Brensinger Architects  
Macauley and Carol Lord  
Robert and Barbara McCue  
Don and Dee Miskill  
*In Memory of Johanna Miskill*  
Alain Montegut, MD and Kathleen Montegut  
Douglas and Georgette Morrell  
Diane Moyer  
Sally Murphy  
MC Hope and John Haug Endowment  
William and Pia Neilson  
Stephen and Jacqueline Norman  
Anonymous  
Herbert and Harriet Paris  
Jonathan Paris  
Jackson and Susan Parker  
Andrea and Todd Patstone  
Maureen Perdue, DO  
Robert Porter  
New England Rehabilitation Hospital of Portland  
John and Kathleen Reny  
Trish Riley  
Susan and Jim Sidel  
Victoria Smith  
Sue and Donald Spann  
James Steuernagle  
Deirdre Strachan and Jose Mas  
Dr. David and Anne Taft  
Joe and Adelaide Trafton  
Lloyd Van Lunen, Jr., M.D. and Margaret Wilson  
Peter and Jean Vaughn  
Linda and Donald Westfall  
Mark Wheeler, MD  
Nancy Wilkes



Eric and Penny Winter  
MC Hope and John Haug Endowment  
Daniel Wood, MD and Linda Wood  
Judy and Dave Woodman

**FOUNDER**  
**\$500-\$999**

Morton and Barbara Achter  
Carol Aderman  
Northern New England Conference of  
Seventh-day Adventists  
Maine Hospital Association  
John Bauman, DDS and Judy Bauman  
Bonnie Beck  
Michael and Judith Bolotsky  
*In Honor of Lynn Jackson, LSW*  
Patricia Bonner  
*In Honor of Dr. Melissa Collard*  
Trina Bragdon  
*In Memory of Bill Bragdon*  
Charles and Susan Bridge  
Lenora Burke and Robert Beaumont  
Paul Burns, MD and Kristin Jhamb, MD  
Frances Caswell  
Darlene Chalmers and Richard Linehan  
*In Honor of Lois Skillings*  
Cathatrine Chase  
*In Memory of Barbara Whitepine*  
Lisa Decesare, FNP and  
Andrew Couture  
Marcus Deck, MD and Sarah Deck  
Deborah and Larry Favreau  
Charles and Carol Frizzle  
Jacob Furey, MD  
Matthew Hanna, MD and  
Amina Hanna, MD  
Jeremy Hardison, MD  
Michelle Harris, MD  
Jonathan and Danielle Hiltz  
Avery Hunt  
Patrick Keaney, MD and  
Kristina Keaney  
Kurt Kelley, MD  
Brock and Denise Kwiatkowski  
Ray Labbe & Sons, Inc.  
Benjamin Lowenstein MD, and  
Elizabeth Lowenstein  
Bruce and Helene McGlaufflin

Janet E. Mead  
Nancy Meikle  
Moore Painting  
Capt. Dexter C. Morrison, USNR-R and  
Juliet Morrison  
*In Memory of Amy L. Morrison*  
Sujata Mukhopadhyay, MD and  
Dr. Sambhu Mukhopadhyay  
Douglas and Nicole Niven  
Louise Paquette  
Jonathan Pelletier  
*In Memory of Robert J. Pelletier*  
Susan Perless  
Arthur and Deborah Pierce  
Matthew Reynolds and  
Denley Poor-Reynolds  
Charles and Nancy Roman  
Renee Schwalberg  
*In Support of*  
*Employee Appreciation Fund*  
Keli Scrapchansky, CRNA  
Charles and Jill Small  
*In Memory of Joyce Herbers*  
John Trumper, MD  
*In Memory of Peter Trumper*  
Carolyn and William Verrill  
*In Memory of Carolyn Verrill*  
Lambert Walker, III  
Marymina Wallis  
Mark and Carol Waltz  
Loren and JB Wright

**BENEFACTOR**  
**\$250-\$499**

Accel Physical Therapy  
Christine Bennett, MD and  
Mr. Bruce Dalbeck  
*In Memory of Patricia Murphy*  
Pamela and Loyd Bowerman  
Barbara Burr  
Carolyn Carney  
April Caron  
Panee M. Coffin  
Jeffrey Cohen and Nancy Heiser  
William and Mary Colbath  
David and Patricia Crump  
Rollin and Averil Fessenden

John Fitzpatrick  
*In Memory of Scott Taylor Wiley*  
David and Catherine Flaherty  
Marybeth Ford, MD and James Ford  
*In Memory of Nick Hyde, MD*  
G&E Roofing Co., Inc.  
John Gullo, MD and Marsha Gullo  
Thomas and Michele Himes  
William E. Howell, DDS and  
Sally Howell  
Peter Hutchinson, MD and Rebecca  
Hutchinson, MD  
Constance Jones-Morris and  
Sam Morris  
Mark and Deedee Jorgensen  
Christina Kapala, DO and Sam Kapala  
Susan Kaplan, PhD  
Mary M. and Gerald P. Kennedy  
Diana Lacey  
Michael and Barbara Mangion  
Michael Mason, MD and  
Heidi Harmon, FNP  
Vincent and Joanne McDermott  
Claus Metzner and Janice McMillen  
Celeste Moreau and Scott Mills, MD  
Richard Moll, DDS and Faith Moll  
Susan Moore  
William Morrell  
Brady Mullin, MD and Anna Cudmore  
Deirdra and Stephen Moriarty  
Thomas and Catharine Nicholson  
*In Memory of Elizabeth Mace and*  
*Melissa M. 11/1/23*  
Matthew and Carrie Orlando  
Carolyn Ranten, DO  
Richard Redlon, Sr.  
Renaissance Charitable Foundation, Inc.  
Elizabeth Richelieu  
Donna Rogers and Philip Grubbs  
Richard Schafer, MD and  
Susan Edinburgh  
SERVPRO of Bath/Brunswick  
Sandra Stevens, MD and  
Timothy Carnes  
Sherry and Russell Tremblay  
William Utley, Jr.  
John Van Orden, MD and  
Jenny Jorgensen

Christopher and Tracy Vaughan  
*In Honor of James and Susan Gillies*  
Joyce Wilson  
Anne Winchester  
MC Constance Smart Granger  
Memorial Endowment  
Ben Young, MD and  
Maggie Wheeler, DO

**PATRON**  
**\$100-\$249**

Michael and Sally Adair  
Paul Aliapoulos  
*In Memory of Janey Aliapoulous*  
Davida Andrew  
Elizabeth Armstrong and  
William Fitzsimmons  
Shannon Banks  
Beacon Chapter #202  
Order of the Eastern Star  
William Beck  
Sherrie Bergman and Donald Quaid  
Rev. Robert Beringer  
Peter and Barbara Bernier  
Reid and Jackie Birdsall  
Arthur Boatin  
Mary Born  
Andrew Bosso  
Richard Brautigam  
Bernard Breitbart and Alison Harris  
Tom and Judy Brown  
Franklin and Nancy Brown  
Beatrice Buchanan  
Joe and Pam Byrnes  
Suzanne Carr, MD and Jan Loeb  
Patricia Carrier and Paul Carrier, MD  
Dana Cary  
Judyth Casey  
Steven Cerf  
Linda Clement  
Melissa Collard, MD  
Knights of Columbus  
St. Thomas Council #13861  
Matthew Corbett MD and  
Christina Corbett  
William and Dorothy Corkhill  
Joyce Courtois  
*In Memory of Patricia Murphy*

Martin and Nancy Damiani  
*In Memory of Martin Damiani*  
David and Anne Daniel  
Lindsay Deinzer  
Josepah Delehant  
Robert and Judith Dent  
Sheila DiCentes  
Philip Dionne  
Linda Docherty  
Jacqueline Drapeau  
Paul and Joanna Dumdey  
Betsy Eaton  
Falmouth Dental Arts  
*In Memory of Patty Murphy*  
Ronald and Jean Flink  
Catherine Fredricks, DO and  
Rep. Daniel Ankeles  
Michele Gaillard and  
Michael Kreindler  
Faith Gardiner and Terry Kungel  
Margaret Gardiner, FNP  
Sally Gemmill  
*In Memory of William F. Gemmill*  
Rosalind and Goodwin Gilman  
John Gilmour  
David and Kathleen Glenn-Lewin  
Jill Goodwin  
*In Memory of Pearl Bergeron*  
Eben Graves  
In support of the employee  
appreciation committee  
Fayal Greene and David Sharpe  
Stephanie Griglun  
Grilljam, LLC  
Deborah Hagler, MD and  
Andrew Hagler  
Janet Hambleton  
*In Memory of Patricia Murphy*  
David and Patricia Hamilton  
Edward Harris, MD and Jane Harris  
Kevin Hart  
Nancy Hasenfus, MD and  
Robert Anderson, MD  
Ann E. Haslett  
Joel and Amanda Hatch  
Michael and Bridget Healy  
*In Memory of Shirley Sullivan*  
Robert Cameron and Eva Heine

Raoul and Vicki Hennin  
*In Memory of Patsy Hennin*  
Constance Henry  
Anne and Roger Howell  
Michael Hoyt  
David Inger, MD and Leora Rabin, MD  
John and Carol Ingram  
Bonita and Mark Jensen  
*In Memory of Patricia Murphy*  
Dorothy and Michael Jones  
Marjorie Katz  
Katherine Jane Kresser  
Alice Lachance and Dana Snyder  
*In Memory of Nick Hyde, MD*  
Martin and Elizabeth Lakeman  
John and Nancy Lambert  
*In Memory of Theodore Lambert*  
Michael and Sissy Leonard  
Robert and Martha Lively  
Edward Lovely, MD and  
Barbara Lovely  
Arnold and Bonnie Lundquist  
Anne and John Marsh  
Alan and Margaret Mast  
Michelle Matson  
*In Memory of Douglas MacIasaac*  
Gloria Maynard  
*In Memory of Kathy Stevens*  
Terrence and Laura McCann  
*In Memory of Douglas MacIsaac*  
Julia McCullough  
*In Memory of Van McCullough*  
Gayla McGlamery and Joe Walsh  
*In Memory of Thomas Garrett*  
Marcey and Gregg McHatten  
Guy and Susan Mendenhall  
Elizabeth Messler  
John and Nancy Moncure  
*In Memory of Nick Hyde, MD*  
Alan and Susan Mooney  
Elizabeth Muench  
Jim and Jane Murphy  
*In Memory of Nick Hyde, MD*  
Nicole Nalchajian, MD and  
David Nalchajian, DDS  
Christina Oddleifson  
Peggy O'Neill  
*In Memory of Thomas Garrett*



Anonymous  
Edward Perry and Cynthia Wood  
Joan Phillips  
    *In Support of  
    Employee Appreciation Fund*  
Michael and Lynne Pinkham  
Carole Pope  
    *In Memory of Gardner and  
    Lillian Pope*  
Larry Lawrence and  
Carole Prendergast  
John and Linda Prybylo  
    *In Memory of Douglas MacIsaac*  
Jana Purrell and Brad Swanson  
Rawson Family  
Lynn Reese  
Rosemary Roberts  
    *In Memory of David L. Roberts and  
    In Honor of Dr. Dumont and  
    the Palliative Team*  
William and Mary Earl Rogers  
Carole Rouillard  
Anonymous  
    *In Honor of Charles Carroll*  
Elizabeth Schuller  
Christopher and Lael Schwabe  
    *In Memory of Nick Hyde, MD*  
James and Claudia Searles  
George and Susan Sergeant  
Tara Marie and Simard  
    *In Memory of Douglas MacIsaac*  
Christine Simonson  
Jessica and Kevin Smith  
    *In Honor of Jim and Susan Gillies*  
Craig and Barbara Snapp  
Ervin and Wanda Snyder  
Andrea Sohacki  
    *In Memory of Patricia Murphy*  
Frances Soverel  
    *In Memory of Nick Hyde, MD*  
James Spencer, MD and Joyce Spencer  
Christopher and Eunice St. John  
Christen Stewart  
Edna Stoddard  
Thomas and Mary Sue Stoner  
Peter and Laura Strauss  
David and Laura Strelitz  
    *In Memory of Raymond and  
    Violette Tetreault*

John Taylor, DO and  
Rebecca Brewster-Taylor  
Peter Tetreault and  
Cara Martin-Tetreault  
Lois Thacker  
Kenneth and Eve Thorson  
Jim and Francie Tolan  
Ann Treglia-Hess  
Roople Unia, MD  
David and June Vail  
Charles and Marian Van Loan  
    *In Honor of the Nurses in Day Surgery*  
Henry and Valerie Vaughan  
David Wallstrom, PA-C and  
Erica Wallstrom  
Melissa Walters, PA-C and  
Robert Black  
Bruce and Kathleen Ward  
Arthur White  
Susan Whitten  
    *In Memory of Kathy Larsen*  
Charles and Mary Jane Wiercinski  
Nick and Becky Wilkoff  
Robert and Ann Williams  
Anthony and Barbara Yuodsnukis

CONTRIBUTER  
\$99 OR LESS

Harold and Rosslyn Adams  
    *In Memory of Mary E. Adams*  
Carol Anderson  
Shannon Bailey  
    *In Memory of Ellen Wanser*  
Duncan and Anne Barnes  
Lisa Bosinger, MD  
Lionel Bourque  
Jorie Catlin, PMHNP  
James Coles  
Knight of Columbus Council 8868  
Michael Daly  
Lois Dole  
Mary Drozdal  
    *In Memory of Patricia Murphy*  
Julie Erb and Herb Thomson  
    *In Memory of Nick Hyde, MD*  
Anne Eustis  
Jessica Faraci, MD  
Keith Fleming, MD

Greg and Nichole Greaves  
George and Virginia Harnois  
Richard Harvey  
    *In Honor of Jane Carter Weir*  
Captain Jerry and Adelaide Jones  
    *In Memory of Adelaide Langbein*  
Larry and Carol Kalajainen  
Richard and Eunice Kelly  
Sally and John Kelsey  
Charlotte Kirkpatrick  
Rev. Ronald Kurtz  
Suzanne Speer Martin and  
Wayne Martin  
Paulette McKeever-Oboyski and  
Victor Oboyski  
Florence Merry  
Anthony and Diane Monaco  
Joan Newton, FNP  
Carol O'Donnell  
James and Susan Oikle  
Patricia Owens  
Oxford Elementary School  
    *In Memory of Douglas MacIsaac*  
Kristin Parris, MD  
Rosalie Paul  
Alden and Pam Perry  
    *In Memory of Herbert and Jeanne Perry*  
James and Kathleen Pierce  
Howard Porter  
    *In Memory of Nancy Porter*  
K & C Rev. Gerard R Proulx  
Assembly 2327  
    *In Memory of Erica DiCentes*  
Linda Robert  
Sam and Linda Saltonstall  
James and Ellen Schneider  
Thomas and Jean Shippee  
Miles Simmons, MD and  
Leslie Simmons  
Cynthia Smith  
Sherry Stultz  
Maybelle Sturgeon  
Burton and Carol Taylor  
Robert Thoden and Debbie Chappell  
    *In Memory of Susan Skirbe*  
Anonymous  
Michael Todd and Kichung Lizée  
    *In Honor of Spiritual Care Chaplains*

Sally Von Benken  
Lennard Warner, III  
Jennifer Weiss  
In support of the Walk-in-Clinic  
Raymond West

IN-KIND

Balaboosta Catering  
Androscoggin Bank  
Back River Bistro  
Bath Savings Institution  
Carol Dube  
Deanne Tibetts  
Enya and Chris Carter  
Escape Room Brunswick  
First Federal Savings  
Franciska Needham  
Freeport Cafe  
General Dynamics-Bath Iron Works  
Gorham Bike & Ski  
Jenna Clifford Therapeutic Massage  
Lobster Cooker  
Maine Maritime Museum  
Portland Sea Dogs  
Red's Eats  
Sue Hansen  
The Montsweag Restaurant  
Town of Bowdoin  
Uprise Hot Yoga + Dance  
Water Lily Flowers and Gifts



**MaineHealth Mid Coast Hospital**

123 Medical Center Drive

Brunswick, ME 04011



[mainehealth.org](http://mainehealth.org)